

LSD型 高端型信号变送器

LSD High-end Signal transducers

■ 用途 Usage

LSD型高端信号变送器将直流电流，直流电压，电位计信号，温度信号，正弦波、矩形波脉冲频率信号，以及编码器或接近光耦开关信号经隔离转换成标准的模拟信号输出或转换成继电器接点信号输出，可直接与数显表相接，也可以与PLC以及计算机系统连接。广泛运用于机械，电力，铁路，船舶，冶金，污水处理行业的自动化系统中。

Type LSD high-end signal transducer can make accurate measurement of DC current voltage, potentiometer, thermistor, thermocouple, pulse frequency, isolate and transmit into standard analog output or relay output. It can directly connect digital display, PLC, DCS, various A/D converter, computer system. So, it is an excellent product with high price performance ratio widely used in automation system of many industries such as machinery, electric power, railway, petrochemical, metallurgical, chemical engineering, sewage treatment and so on.

■ 特点 Feature

测量：直流电压，直流电流。位移，工频频率信号，脉冲频率（光耦，接近开关），镍1000（Ni1000）、Pt100热电阻温度信号，热电偶温度信号K、E、R型
精度：≤±0.1%RO
隔离方式：输入、输出、电源三方完全隔离。抗干扰强。
输出：4~20mA, 0~20mA, 0~10V, 0~±10V, 继电器等。
工作电源：DC24V, DC110V, DC220V, AC220V等。
主要特点：超强抗电磁干扰能力

Measure: DC Voltage, DC Current, Potentiometer, electric frequency, pulse frequency (opto-coupler, inductive proximity switch), Ni1000, Pt100 thermistor, K, E, R type thermocouple.
Accuracy: ≤±0.1%RO.
Isolation: Between input/output/power supply.
Output: 4~20mA, 0~20mA, 0~10V, 0~±10V, Relay and so on.
Power supply: DC24V, DC110V, DC220V, AC220V and special.
Main feature: Strong anti-electromagnetism interference ability

■ 技术参数 Technical parameters

输入信号 Input signal	直流电压、直流电流、电位计、频率、热电阻、热电偶 DC Voltage, DC Current, Potentiometer, Frequency, Thermistor, Thermocouple
响应时间 Response time	<400mSec.
输出电流电压 Output voltage	4~20mA, 0~20mA, 0~10mA, 0~10Vdc, 0~±10V, 1~5Vdc, 0~5Vdc, and special
输出继电器 Output relay	Relay contact 30V 40mA
输出负载 Output overload	电流输出时<750Ω, 电压输出时>1000Ω Output current <750Ω, Output voltage >1000Ω
输出满度校调 Span adjustment	≤±20% of R.O.
输出零点校调 Zero adjustment	≤±10% of R.O.
工作电源 Power supply	AC220V±10%、AC110V、DC220V、DC110V、DC24V±20%
电源功耗 Consumption	直流供电<3W, 交流供电<4VA DC Power <3W, AC Power <4VA
外壳材料 Case material	ABS
隔离 Isolation	输入/输出/电源/外壳 互相隔离 Between input/output/power/case
耐压强度 Isolation voltage	AC2KVrms/min
绝缘阻抗 Insulation resistance	>100MΩ, DC500V
工作环境温湿度 Operating temperature humidity	— 10℃~55℃, <80%相对湿度(无冷凝状态) — 10℃~55℃, <80%Relative humidity(non-condensing)
储存环境温湿度 Storage temperature humidity	— 20℃~70℃, <70%相对湿度(无冷凝状态) — 20℃~70℃, <70%Relative humidity(non-condensing)
外型尺寸 Case dimension	112mm(长)×65mm(宽)×70mm(高) 112 mm(Length)×65mm(Width)×70mm(Height)
安装方式 Mounting	标准导轨35mm, 或螺钉固定 DIN rail 35mm, or fix to cubicle with bolt
重量 Weight	<200克 <200g

外型尺寸 Dimension

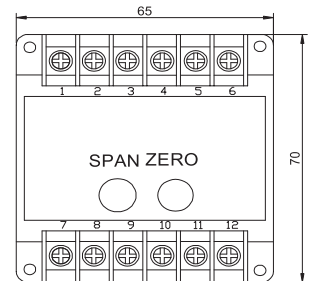
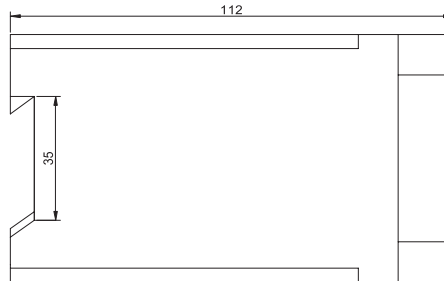

选型代码 Model Code

企业代码 Company code	功能代码 Function code	输入代码 Input code				脉冲电压 Pluse voltage		输出代码 Output code	工作电源代码 Aux.power		
LSD-	V 直流电压 DC voltage	A4	4~20mA	H1	0~50Hz	P1	5V	1	4~20mA	D	DC24V
		A2	0~20mA	H2	0~100Hz	P2	12V	2	0~20mA	A2	AC220V
	A 直流电流 DC current	A1	0~10mA	H3	0~10KHz	P3	24V	3	0~10mA	A1	AC110V
		A0	0~1mA	H4	0~30KHz	Y	Special	4	0~1mA	D2	DC220V
	N 镍1000 Ni 1000	A3	0~5A	A	0~130°C			5	1~5V	D1	DC110V
		V0	1~5V	B	0~200°C			6	0~10V	Y	Special
	F 频率 Frequency	V1	0~10V	C	0~800°C			7	2~10V		
		V2	2~10V	D	0~1100°C			8	0~5V		
	PM 电位计 Potentiometer	V3	0~5V	E	0~1600°C			9	0~75mV		
		V4	0~300V	R1	0~1KΩ			0	0~±75mV		
	P Pt100	V5	0~500V	R2	0~5KΩ			10	0~±10V		
	K K type	V6	0~75mV	R3	0~10KΩ			R	Relay		
		D	0~±75mV	R4	0~50KΩ			Y	Special		
		E	0~±10V	Y	Special						

订货范例 Order example

型号 Model : LSD-VV61D2
 输入 Input : 0~75mVdc
 输出 Output : 4~20mAdc
 工作电源 Aux.power : DC220V

接线图 Connection Diagram

